

The Corporation of Norfolk County

By-Law 2024-121

Being a By-Law to Amend Zoning By-Law 1-Z-2014, as amended, for property described as Part of Block A, Long Point, South Walsingham, being Part 1 on Plan 37R4997, Norfolk County.

WHEREAS Norfolk Council is empowered to enact this By-Law, by virtue of the provisions of Section 34 of the Planning Act, R.S.O. 1990, CHAPTER P.13, as amended;

AND WHEREAS this By-Law conforms to the Norfolk County Official Plan.

NOW THEREFORE the Council of The Corporation of Norfolk County hereby enacts as follows:

1. That Schedule A of By-Law 1-Z-2014, as amended, is hereby further amended by changing the zoning of the subject lands identified on Map A (attached to and forming part of this By-Law) from Provincially Significant Wetland (PSW) *Zone* to Provincially Significant Wetland (PSW) *Zone* with a Special Provision 14.1069.
2. That Subsection 14 Special Provisions is hereby further amended by adding Special Provision 14.1069 as follows:

14.1069 In addition to the uses permitted in the Provincially Significant Wetland (PSW) *Zone*, the following shall be applied:

- a) a research station

In lieu of the corresponding provisions in the Provincially Significant Wetland (PSW) *Zone*, the following shall apply:

- a) maximum number of structures – 9
- b) maximum total floor area of all structures – 235 sq. m.

3. That this By-Law shall become effective upon the approval of the related Amendment number 165 to the Norfolk County Official Plan.

ENACTED AND PASSED this 19th day of November, 2024.

Mayor: A. Martin

County Clerk: W. Tigert

MAP A

ZONING BY-LAW AMENDMENT NORFOLK COUNTY In the Geographic Township of SOUTH WALSINGHAM

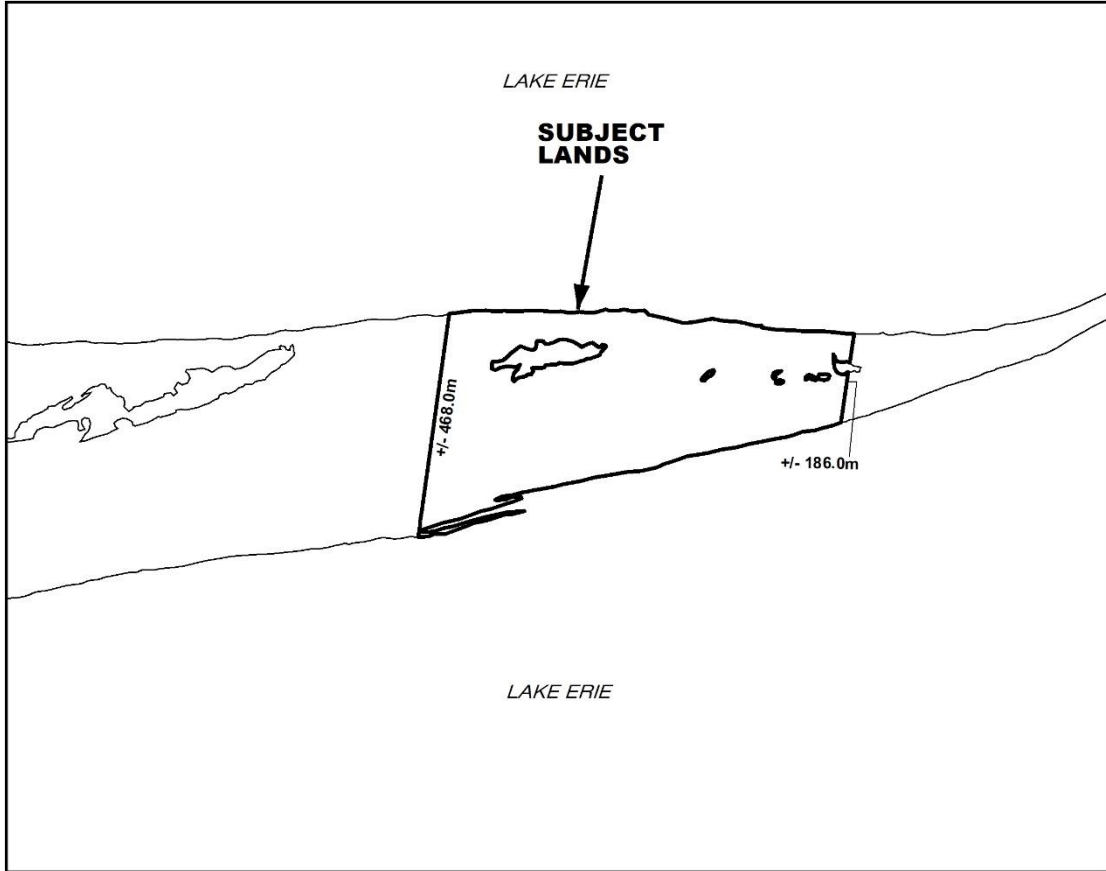
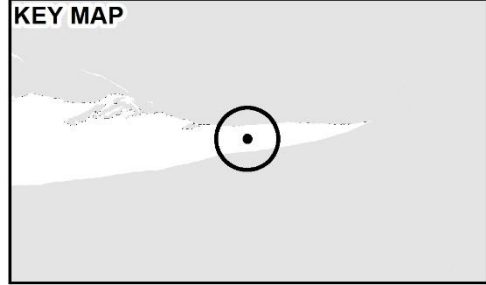

LEGEND

 Subject Lands

ZONING BY-LAW 1-Z-2014

(H) - Holding

HL - Hazard Land Zone

From: Provincially Significant Wetland Zone
To: Provincially Significant Wetland Zone
with Special Provision

PSW - Provincially Significant Wetland Zone



1:12,000

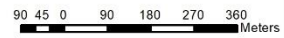

This is MAP A to Zoning By-law _____ Passed the ___ day of _____.

Mayor: A. Martin

Clerk

**Explanation of the Purpose and Effect of
By-Law 2024-121**

This By-Law affects a parcel of land described as Part of Block A, Long Point, South Walsingham, being Part 1 on Plan 37R4997.

The purpose of this By-Law is to add “research station” as a permitted use on the subject lands, with the additional provision for a maximum of 9 structures and a total floor area of all buildings combined of 235 square metres.